

**ROAD PROJECTS**

	2007 SEAL COAT
	2008 SEAL COAT
	2009 SEAL COAT
	2010 SEAL COAT
	2011 SEAL COAT
	2012 SEAL COAT
	2013 SEAL COAT
	2014 SEAL COAT
	2015 SEAL COAT
	2016 SEAL COAT
	2017 SEAL COAT
	OTHER PROJECT

**LEGEND**

	INTERSTATE HIGHWAY
	STATE HIGHWAY
	COUNTY ROAD; PRIMARY SYSTEM (PAVED)
	COUNTY ROAD; LOCAL SYSTEM (PAVED)
	COUNTY ROAD; LOCAL SYSTEM (UNPAVED)
	PRIVATE ROAD
	PUBLIC ROAD (NOT OPEN)
	ADJACENT COUNTY ROAD
	RAILROADS

PRIMARY ROAD SYSTEM IS 22.95 MILES  
 LOCAL ROAD SYSTEM IS 22.99 MILES

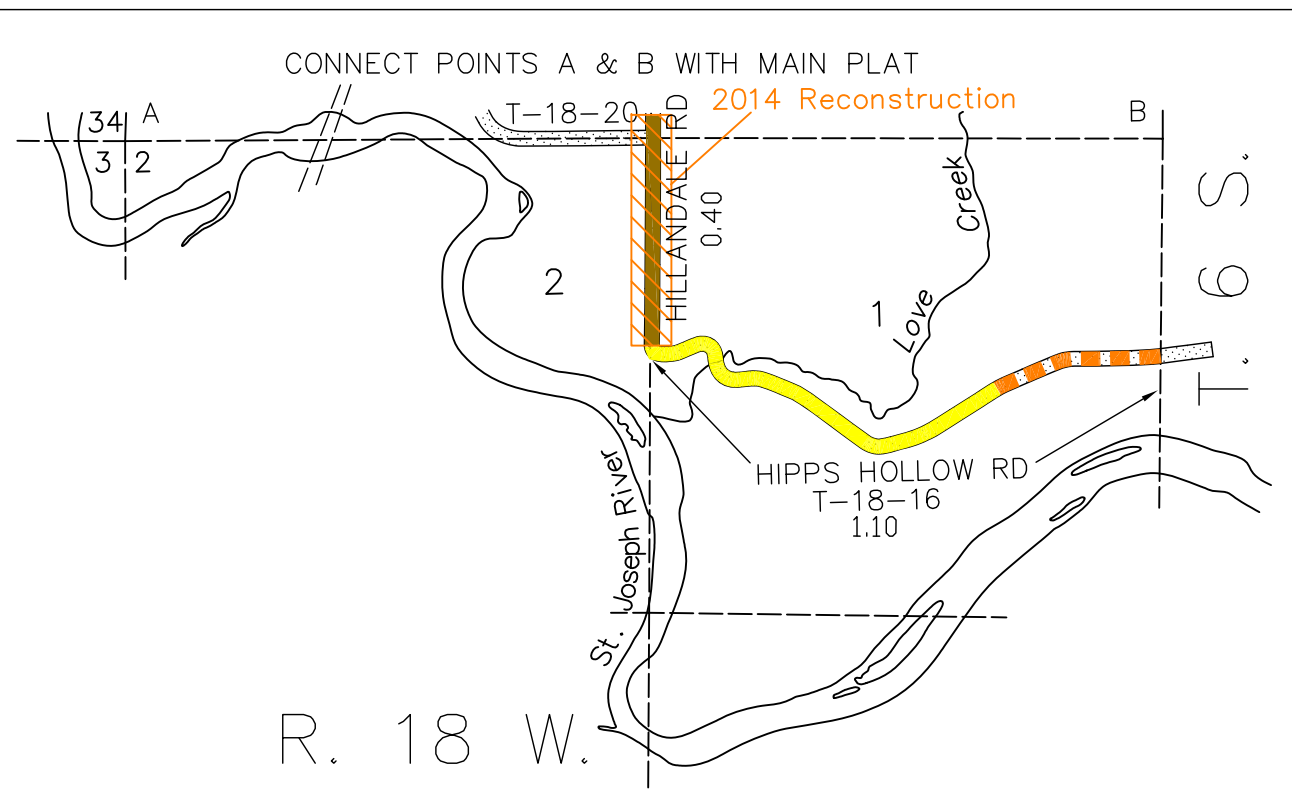

SODUS TOWNSHIP

BERRIEN COUNTY  
 ROAD DEPARTMENT  
 BENTON HARBOR, MICHIGAN

BRIAN Q. BERNDT, COUNTY HWY ENGINEER

SCALE: 1"=2000' DATE: January, 2018

No. 18