

2014 Grind & Gravel
2015 Prime & Double Seal

- ### ROAD PROJECTS
- 2006 SEAL COAT
 - 2007 SEAL COAT
 - 2008 SEAL COAT
 - 2009 SEAL COAT
 - 2010 SEAL COAT
 - 2011 SEAL COAT
 - 2012 SEAL COAT
 - 2013 SEAL COAT
 - 2014 SEAL COAT
 - 2015 SEAL COAT
 - 2016 SEAL COAT
 - OTHER PROJECT

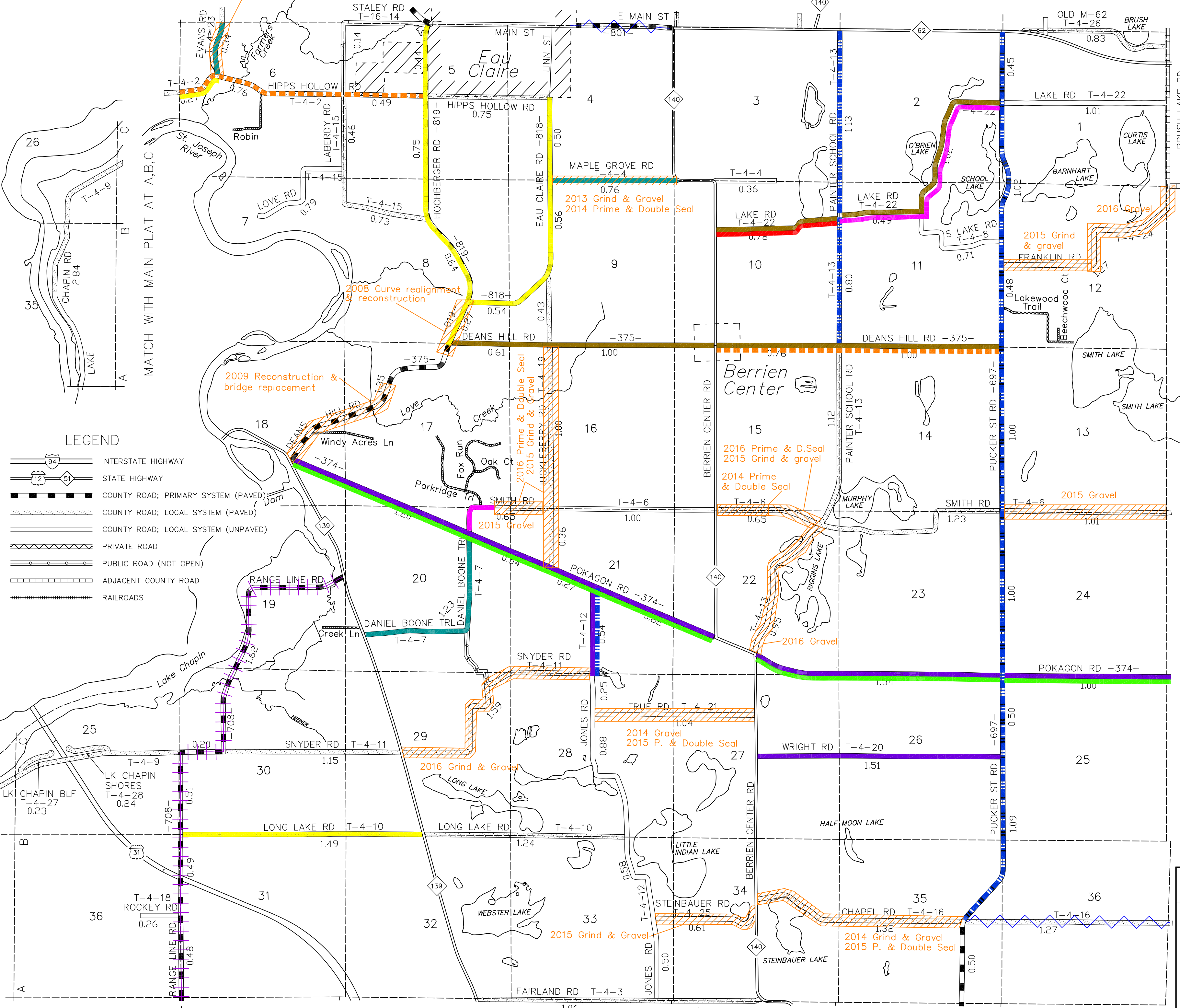

LEGEND

- INTERSTATE HIGHWAY
- STATE HIGHWAY
- COUNTY ROAD; PRIMARY SYSTEM (PAVED)
- COUNTY ROAD; LOCAL SYSTEM (PAVED)
- COUNTY ROAD; LOCAL SYSTEM (UNPAVED)
- PRIVATE ROAD
- PUBLIC ROAD (NOT OPEN)
- ADJACENT COUNTY ROAD
- RAILROADS

T. 6 S.
Cass County

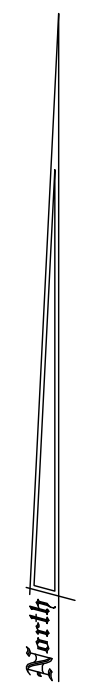

PRIMARY ROAD SYSTEM IS 23.13 MILES
LOCAL ROAD SYSTEM IS 42.79 MILES

BERRIEN TOWNSHIP
BERRIEN COUNTY
ROAD COMMISSION
BENTON HARBOR, MICHIGAN
BRIAN Q. BERNDT, COUNTY HWY ENGINEER
SCALE: 1"=2000' DATE: January, 2016
No. 4

R. 18 W.

R. 17 W.