

FOR NORTH NILES, SEE PAGE 14-(1)

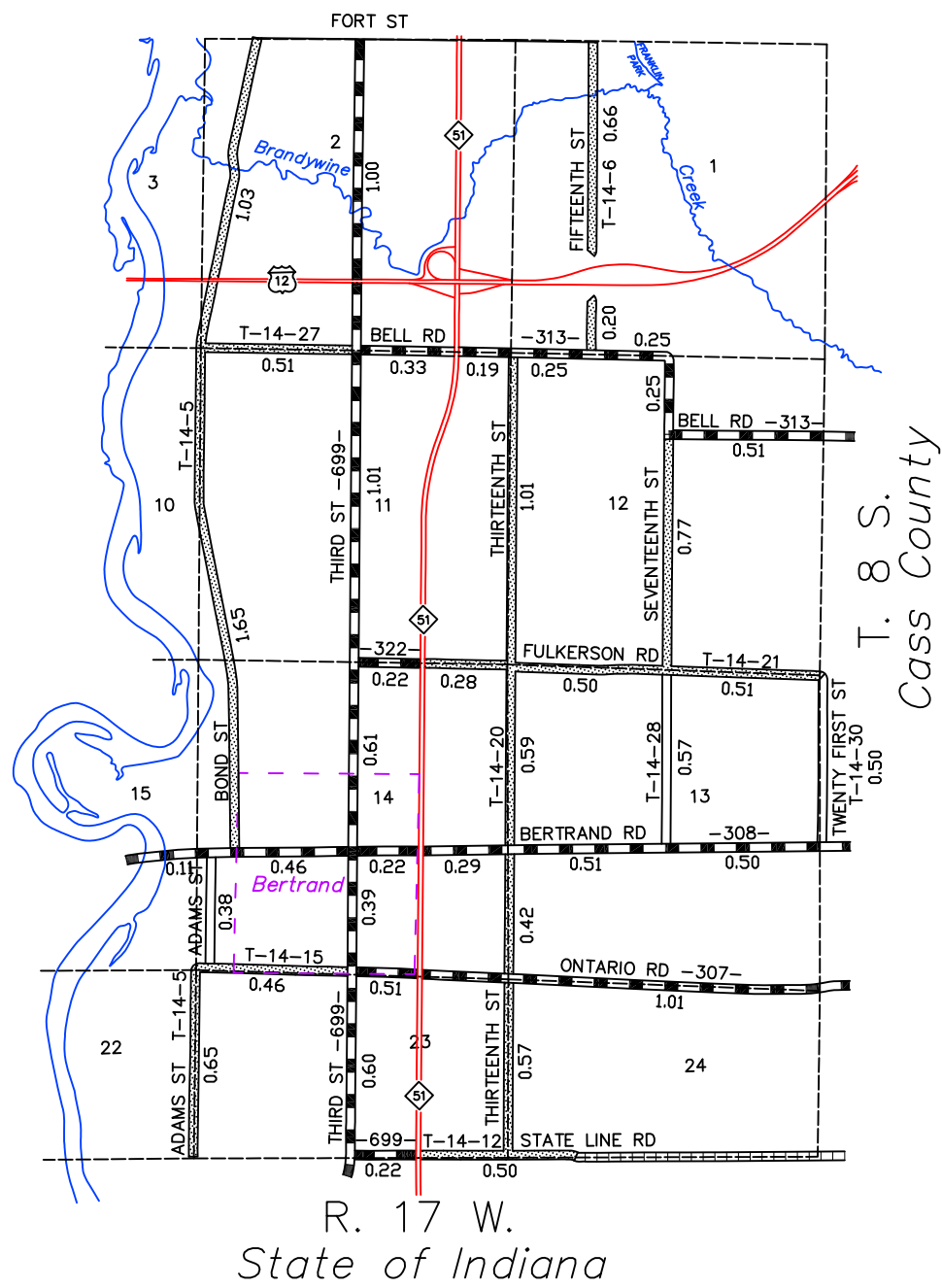

LEGEND

- INTERSTATE HIGHWAY
- STATE HIGHWAY
- COUNTY ROAD; PRIMARY SYSTEM (PAVED)
- COUNTY ROAD; LOCAL SYSTEM (PAVED)
- COUNTY ROAD; LOCAL SYSTEM (UNPAVED)
- PRIVATE ROAD
- PUBLIC ROAD (NOT OPEN)
- ADJACENT COUNTY ROAD
- RAILROADS

PRIMARY ROAD SYSTEM IS 9.44 MILES
 LOCAL ROAD SYSTEM IS 11.76 MILES

NILES TOWNSHIP

BERRIEN COUNTY
 ROAD COMMISSION
 BENTON HARBOR, MICHIGAN

BRIAN Q. BERNDT, COUNTY HWY ENGINEER

SCALE: 1"=2000' DATE: January, 2017

No. 14-(2)