

FOR NORTH NILES, SEE PAGE 14--(1)
 FORT ST

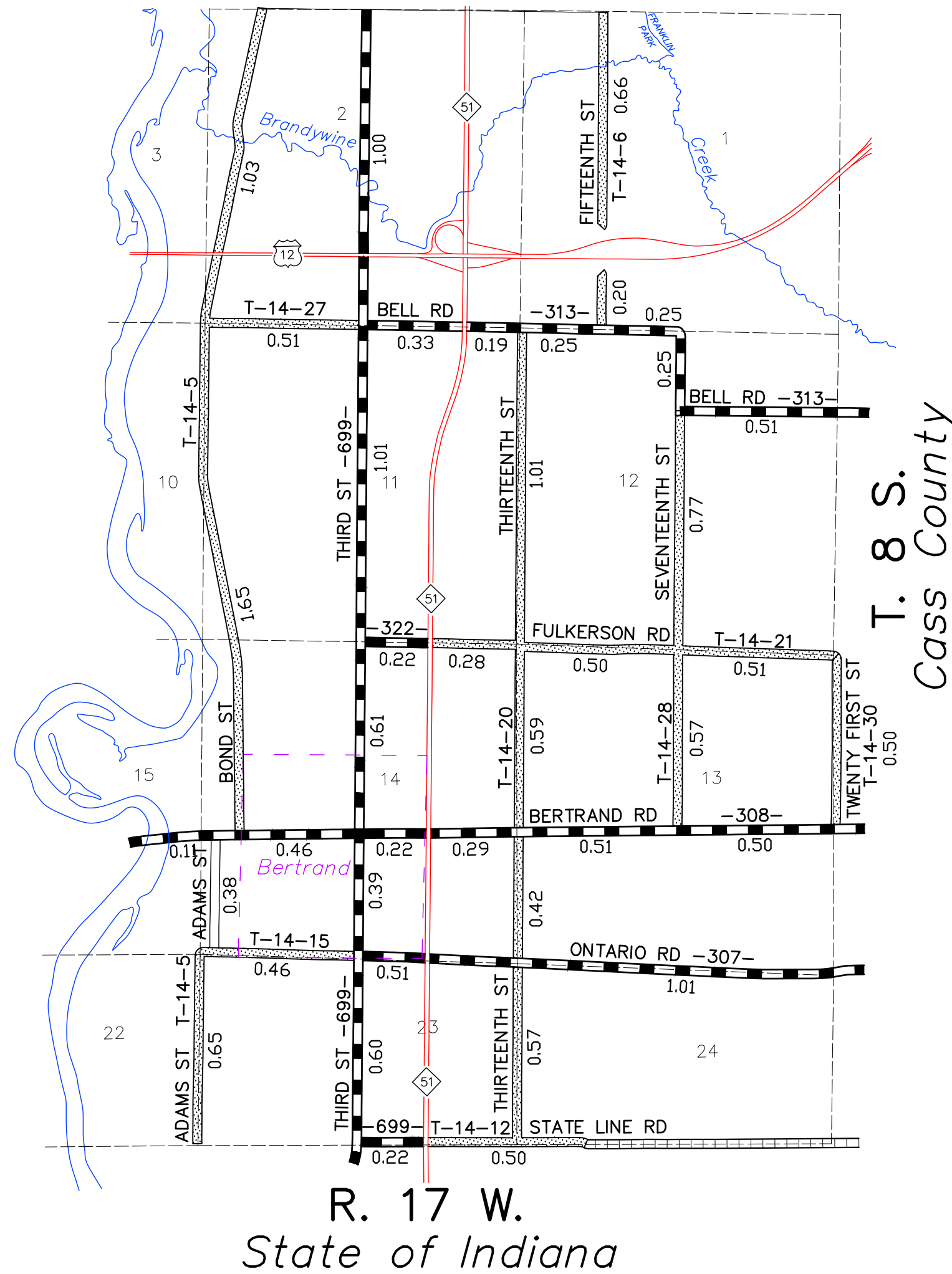

LEGEND

- INTERSTATE HIGHWAY
- STATE HIGHWAY
- COUNTY ROAD; PRIMARY SYSTEM (PAVED)
- COUNTY ROAD; LOCAL SYSTEM (PAVED)
- COUNTY ROAD; LOCAL SYSTEM (UNPAVED)
- PRIVATE ROAD
- PUBLIC ROAD (NOT OPEN)
- ADJACENT COUNTY ROAD
- RAILROADS

PRIMARY ROAD SYSTEM IS 9.44 MILES
 LOCAL ROAD SYSTEM IS 11.76 MILES

NILES TOWNSHIP

BERRIEN COUNTY
 ROAD DEPARTMENT
 BENTON HARBOR, MICHIGAN

KEVIN STACK, COUNTY HWY ENGINEER
 SCALE: 1"=2000' DATE: January, 2022